

# Forged Steel (F22) 2 500 lb Socketweld 1/2" - 2"

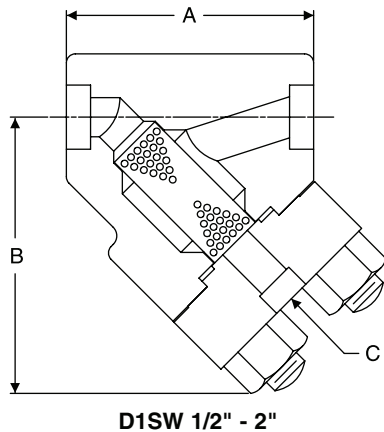

## Pressure/Temperature Rating

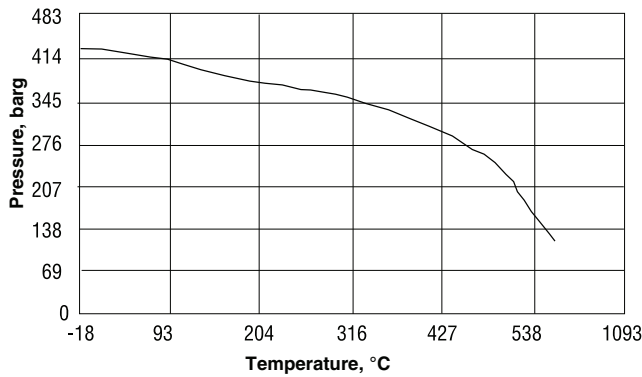

**Table S-327-1. Materials: 2 500 lb Socketweld 1/2" - 2"**

Connection Size in	Body	Screen Retainer	Gasket	Bolting	Standard Screen
1/2", 3/4", 1", 1 1/4", 1 1/2", 2"	ASTM A182 Gr. F22	ASTM A182 Gr. F22	347 SS Spiral Wound Non-asbestos	Studs ASTM A193 Gr. B16 Nuts ASTM A194 Gr. 2H	304 SS 0,045" Perforated †

† Note: Other screen materials available. See page S-321.

**Table S-327-2. Physical Data: 2 500 lb Socketweld 1/2" - 2"**

Connection Size in	Ordering Code, Standard Screen	Weight kg	Dimensions			Maximum Pressure		Screen Retainer Type	Connections
			A mm	B mm	C* in	Saturated Steam bar	38°C non-shock bar		
1/2"	D1SW	12	130	143	1/2"	172	414	Bolted	ANSI B16.11 Socketweld
3/4"									
1"									
1 1/2"	D1SW	25	168	187	1/2"	172	414	Bolted	
1 1/4"									
2"									

\* Socketweld blowdown connections for 1/2" pipe.

Shade indicates products that are CE Marked according to the PED (97/23/EC). All the other sizes comply with the Article 3.3 of the same directive.

**All dimensions and weights are approximate. Use certified print for exact dimensions. Design and materials are subject to change without notice.**